

## NHMLA Car Park

# Guests

### From the 110 Freeway

- ❖ Exit Exposition Blvd.
- ❖ West towards Vermont Ave.
- ❖ Left onto Bill Robertson Lane.

### From the 10 Freeway

- ❖ Exit Vermont Ave.
- ❖ South towards Exposition Blvd.
- ❖ Left onto Exposition Blvd.
- ❖ Right on Bill Robertson Lane.

 Please follow signs to the Museum entrance once parked.

**NATURAL  
HISTORY  
MUSEUM**  
LOS ANGELES COUNTY

*Please drive slowly.*

900 Exposition Boulevard  
Los Angeles, CA 90007

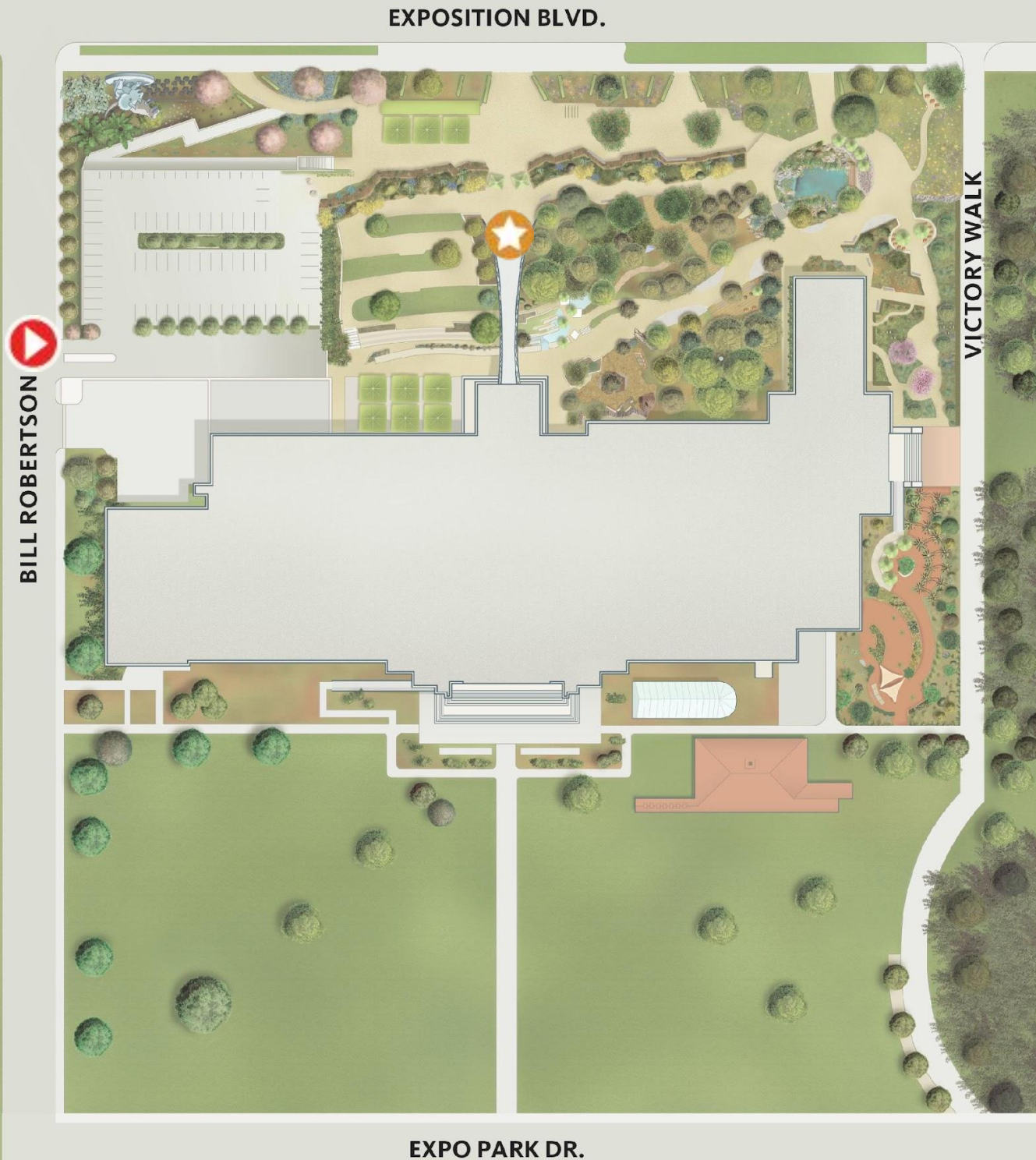

## NHMLA Car Park

# Guests

### From the 110 Freeway

- ❖ Exit Exposition Blvd.
- ❖ West towards Vermont Ave.
- ❖ Left onto Bill Robertson Lane.

### From the 10 Freeway

- ❖ Exit Vermont Ave.
- ❖ South towards Exposition Blvd.
- ❖ Left onto Exposition Blvd.
- ❖ Right on Bill Robertson Lane.

 Please follow signs to the Museum entrance once parked.

**NATURAL  
HISTORY  
MUSEUM**  
LOS ANGELES COUNTY

*Please drive slowly.*

900 Exposition Boulevard  
Los Angeles, CA 90007

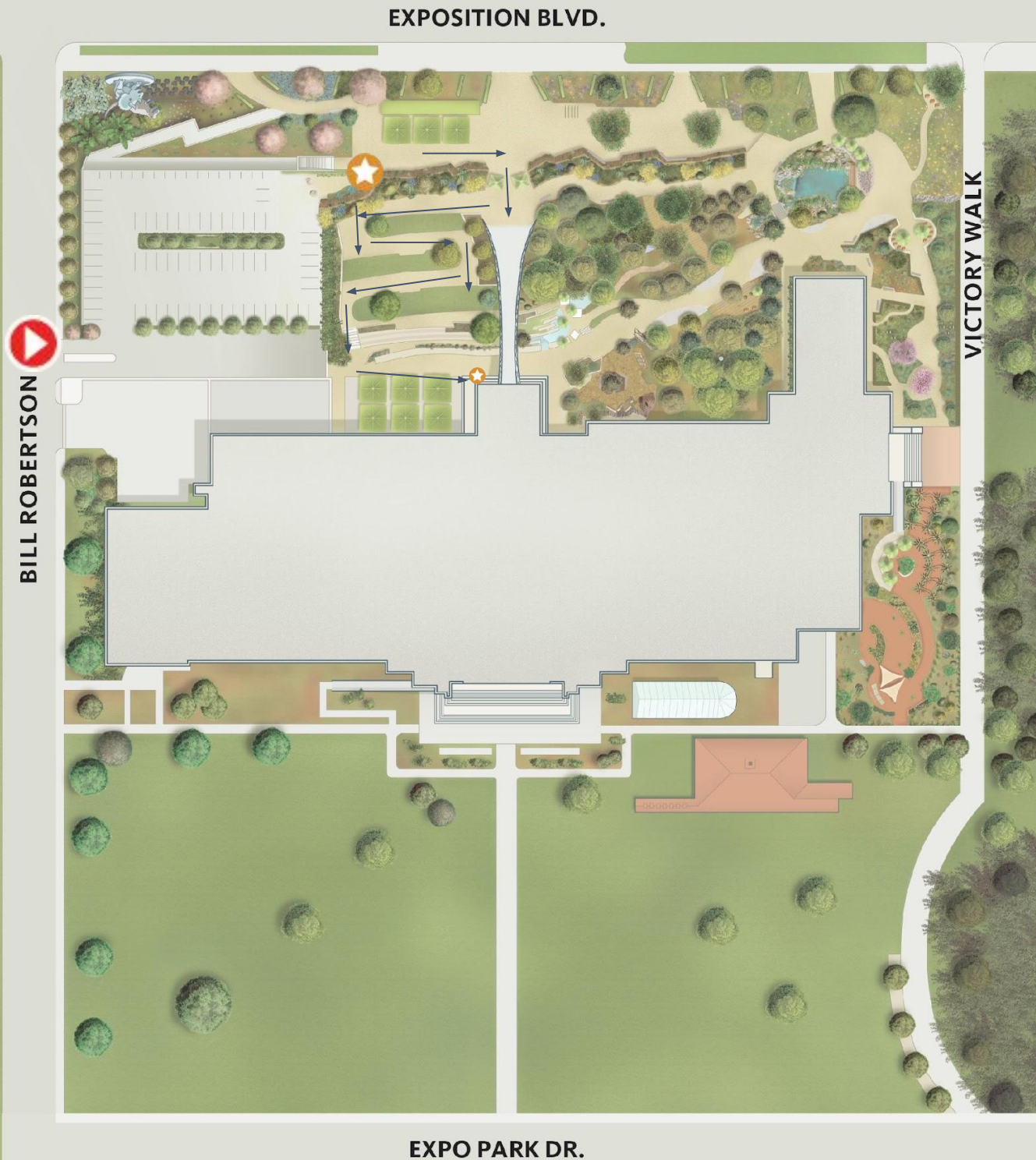

## NHMLA Car Park

# Guests

### From the 110 Freeway

- ❖ Exit Exposition Blvd.
- ❖ West towards Vermont Ave.
- ❖ Left onto Bill Robertson Lane.

### From the 10 Freeway

- ❖ Exit Vermont Ave.
- ❖ South towards Exposition Blvd.
- ❖ Left onto Exposition Blvd.
- ❖ Right on Bill Robertson Lane.

 Please follow signs to the Museum entrance once parked.

 North Ticketing Booth

 Upper Otis Booth Pavilion

**NATURAL  
HISTORY  
MUSEUM**  
LOS ANGELES COUNTY

*Please drive slowly.*

900 Exposition Boulevard  
Los Angeles, CA 90007

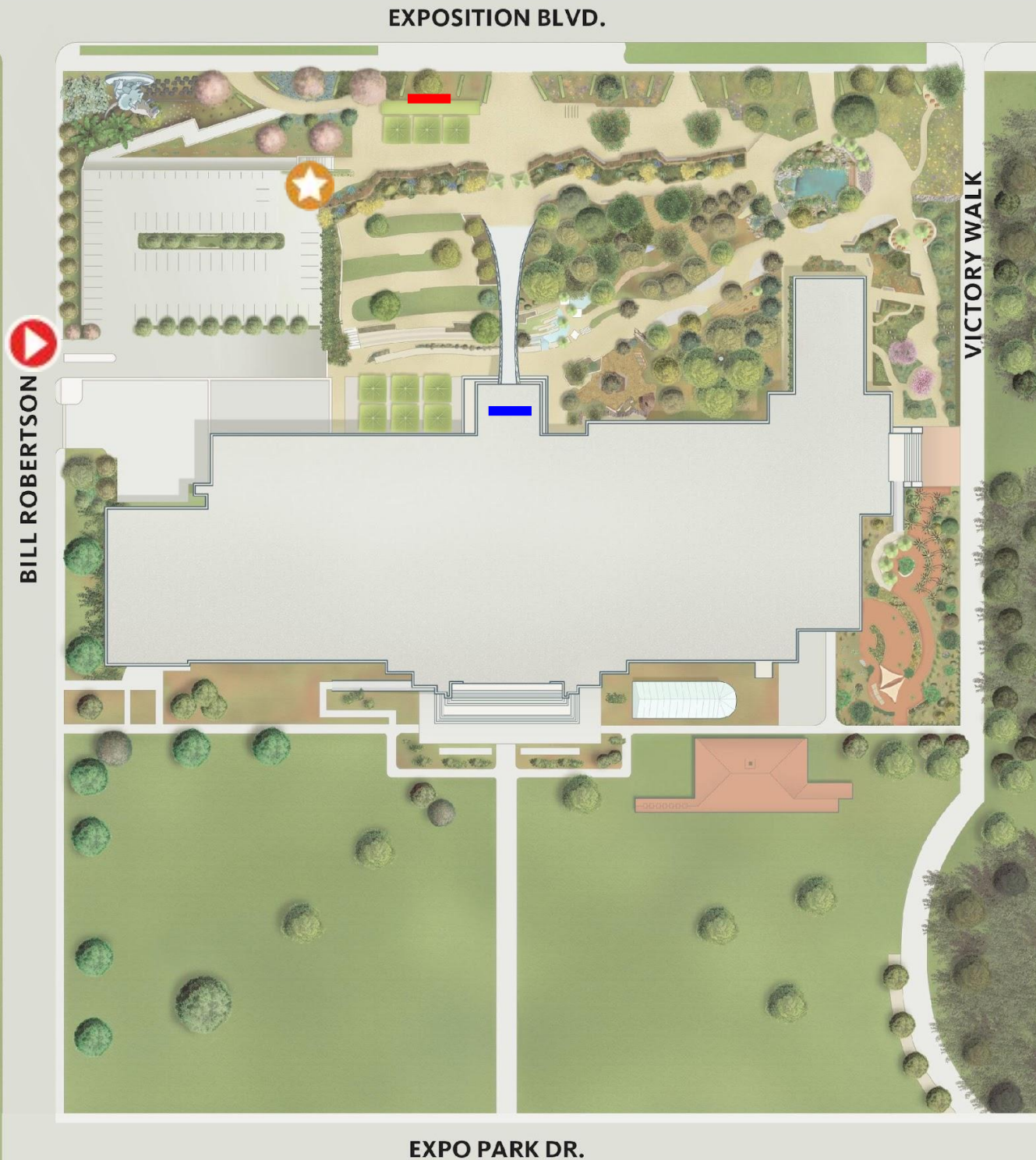

## NHMLA Car Park

# Guests Drop Off on Bill Robertson Lane

### From the 110 Freeway

- ❖ Exit Martin Luther King Jr. Blvd.
- ❖ West towards Vermont Ave.
- ❖ Right onto Bill Robertson Lane

### From the 10 Freeway

- ❖ Exit Vermont Ave.
- ❖ South towards Exposition Blvd.
- ❖ Left onto Exposition Blvd.
- ❖ Right on Bill Robertson Lane.

 Please drop off guests on the curb at the entrance to Museum Car Park

 Please follow signs to the Museum entrance once parked.

**NATURAL  
HISTORY  
MUSEUM**  
LOS ANGELES COUNTY

*Please drive slowly.*

900 Exposition Boulevard  
Los Angeles, CA 90007

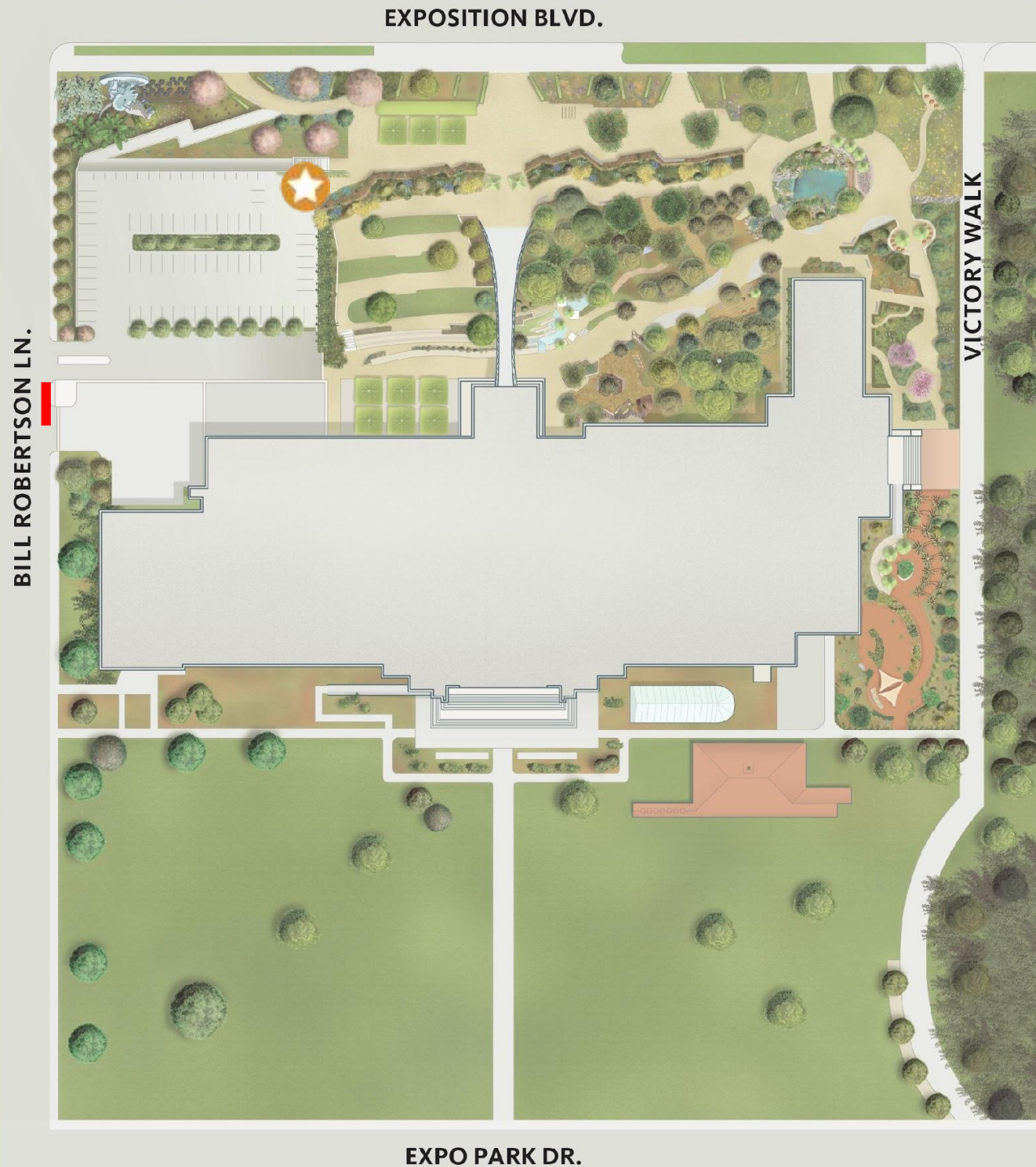

## NHMLA Car Park

# Guest Drop Off

### From the 110 Freeway

- ❖ Exit Exposition Blvd.
- ❖ West towards Vermont Ave.
- ❖ Left onto Bill Robertson Lane.

### From the 10 Freeway

- ❖ Exit Vermont Ave.
- ❖ South towards Exposition Blvd.
- ❖ Left onto Exposition Blvd.
- ❖ Right on Bill Robertson Lane.

**\*Please note for larger vehicles: Your vehicle must be able to make tight turns, and must have a height of less than 8ft.**

 Please follow the red arrow to enter.

 Please drop off guest at the entrance to North Plaza

 Please follow the blue arrow to exit.

**NATURAL  
HISTORY  
MUSEUM**  
LOS ANGELES COUNTY

*Please drive slowly.*

900 Exposition Boulevard  
Los Angeles, CA 90007

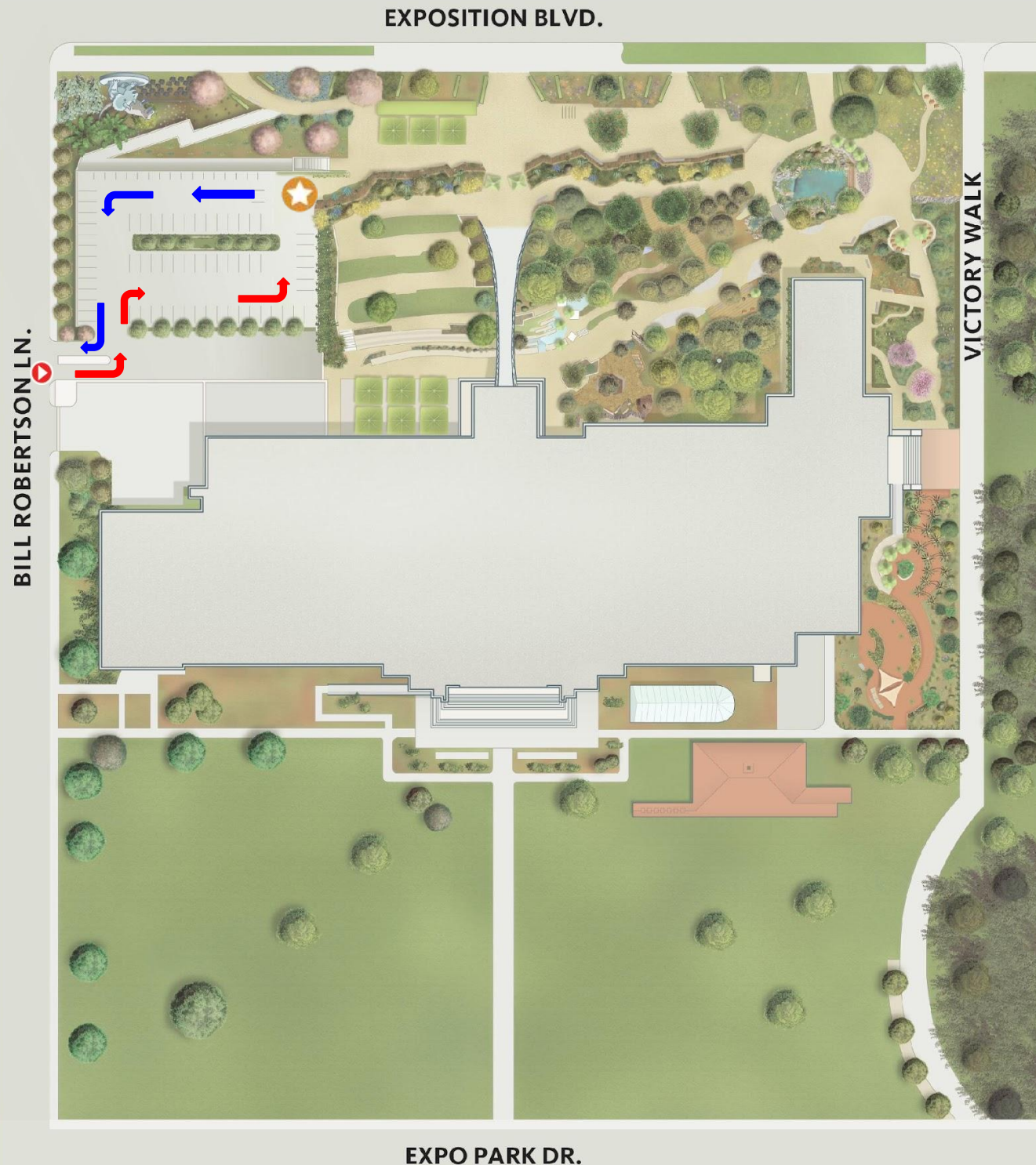

## NHMLA Car Park

# Guests Drop Off on Exposition Blvd.

### From the 110 Freeway

- ❖ Exit Martin Luther King Jr. Blvd.
- ❖ West towards Vermont Ave.
- ❖ Right onto Bill Robertson Lane
- ❖ Right onto Exposition Blvd.

### From the 10 Freeway

- ❖ Exit Vermont Ave.
- ❖ South towards Exposition Blvd.
- ❖ Left onto Exposition Blvd.

Please drop off guests on the curb at the entrance to the Museum's North Gate. Please see next page for photos of this space.

 Please follow signs to the Museum entrance once parked.

**NATURAL  
HISTORY  
MUSEUM**  
LOS ANGELES COUNTY

*Please drive slowly.*

900 Exposition Boulevard  
Los Angeles, CA 90007

BILL ROBERTSON LN.



EXPOSITION BLVD.

VICTORY WALK

EXPO PARK DR.

# Van Entering on Exposition Blvd.

## From the 110 Freeway

- ❖ Exit Martin Luther King Jr. Blvd.
- ❖ West towards Vermont Ave.
- ❖ Right onto Bill Robertson Lane
- ❖ Right onto Exposition Blvd.

## From the 10 Freeway

- ❖ Exit Vermont Ave.
- ❖ South towards Exposition Blvd.
- ❖ Left onto Exposition Blvd.

Please hop the curb here and drive a bit down to the right where the gate will be opened.



Van Entrance.

**NATURAL  
HISTORY  
MUSEUM**  
LOS ANGELES COUNTY

*Please drive slowly.*

900 Exposition Boulevard  
Los Angeles, CA 90007

BILL ROBERTSON LN.

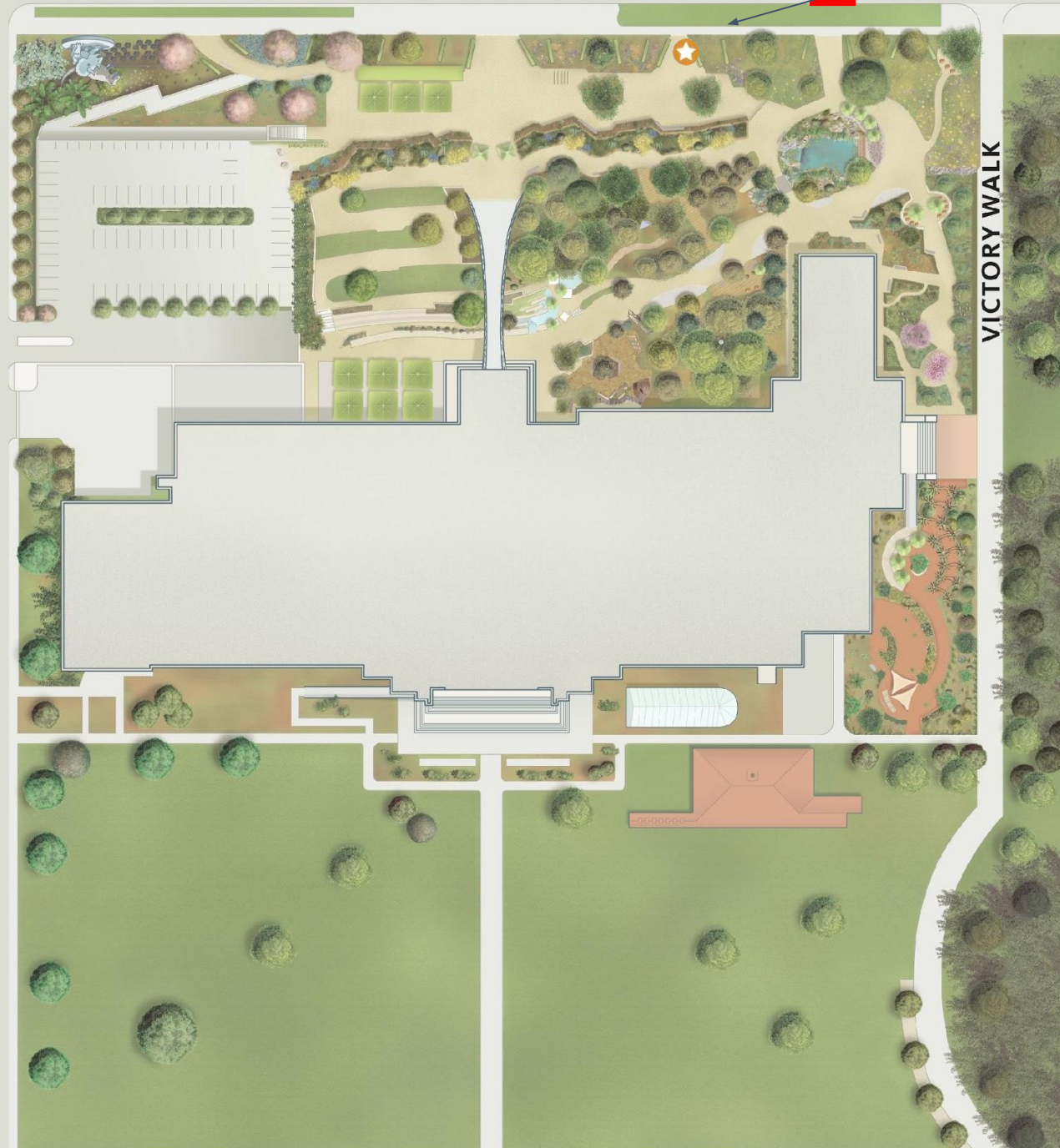

EXPOSITION BLVD.

VICTORY WALK

EXPO PARK DR.

# Van Entering on Exposition Blvd.

## From the 110 Freeway

- ❖ Exit Martin Luther King Jr. Blvd.
- ❖ West towards Vermont Ave.
- ❖ Right onto Bill Robertson Lane
- ❖ Right onto Exposition Blvd.

## From the 10 Freeway

- ❖ Exit Vermont Ave.
- ❖ South towards Exposition Blvd.
- ❖ Left onto Exposition Blvd.

Please hop the curb here and drive a bit down to the right where the gate will be opened.



Van Entrance.

**NATURAL  
HISTORY  
MUSEUM**  
LOS ANGELES COUNTY

*Please drive slowly.*

900 Exposition Boulevard  
Los Angeles, CA 90007

BILL ROBERTSON LN.

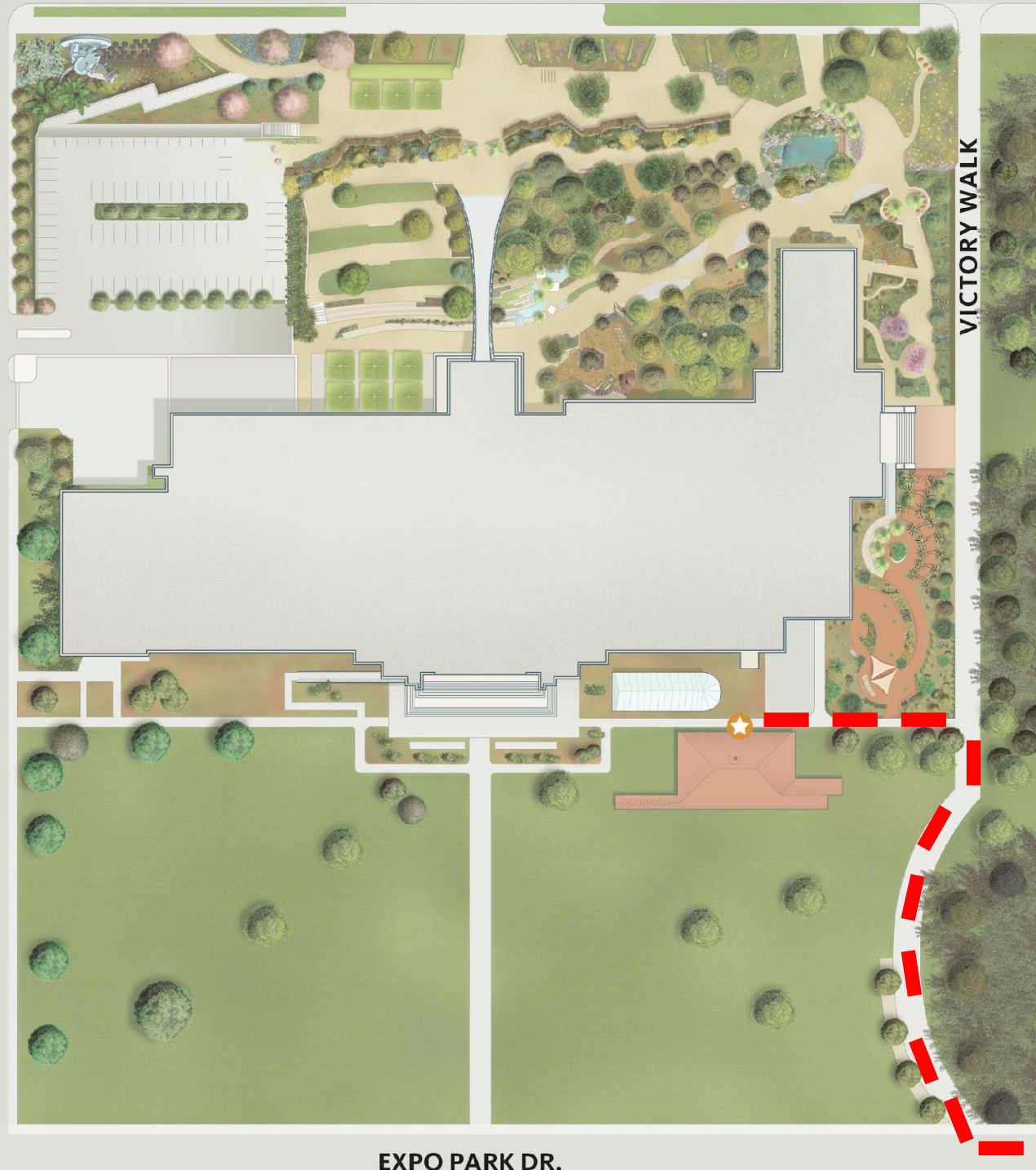

EXPOSITION BLVD.

VICTORY WALK

EXPO PARK DR.



# Guests Drop Off on Exposition Blvd.

Top: Existing Curb Cut on Exposition Blvd. for bus drop-off

Bottom Left: View of Gate adjacent to Curb Cut; Would be open for guest arrivals/departures

Bottom Right: View looking in from gate



**NATURAL  
HISTORY  
MUSEUM**  
LOS ANGELES COUNTY

900 Exposition Boulevard  
Los Angeles, CA 90007